

# GSBV 1222



## CHARACTERISTICS



- Bellows coupling in a very small design with a length of 22 mm and a diameter of 12 mm.
- Clamp fixing system.
- Coupling realised with a non-magnetic bellow made of bronze and hubs made of nickel-plated brass.

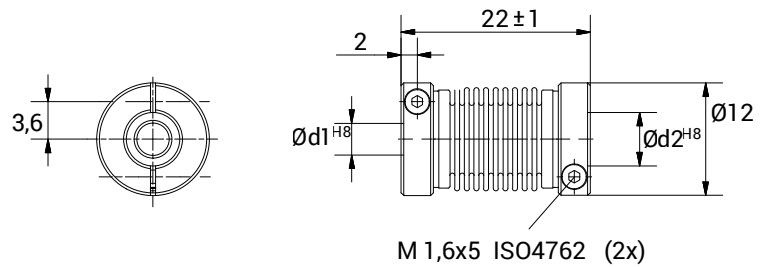

TECHNICAL DATA		
Maximum speed	min <sup>-1</sup>	10.000
Maximum torque	Ncm	15
Radial misalignment max.	mm.	± 0,2
Axial misalignment max.	mm.	± 0,4
Angular misalignment max.	degree	± 2,5
Torsional stiffness	Nm/rad	45
Radial stiffness	N/mm	30
Moment of inertia	gcm <sup>2</sup>	2,5
Clamping torque max.	Ncm	30
Working temperature range	°C	-40/+140
Weight	g	8
Hubs material		Brass nickel-plated
Bellow material		Bronze nickel-plated

DIMENSIONS		
External diameter	Ø	12
Length	mm.	22
Screw thread		M 1,6x5
Screw position	mm.	2
S	mm.	3,6
Standard hole combinations d1 H8 / d2 H8	mm.	2/2 - 2/3 - 2/4 - 2/5 - 3/3 - 3/4 - 3/5 4/4 - 4/5 - 5/5