

GMYG 2224

STAINLESS STEEL AISI 316L



CHARACTERISTICS



- Coupling realised with hubs in stainless steel AISI 316L and glass fiber-reinforced polyamide body, offers high corrosion resistance and also electrically and thermally insulating.

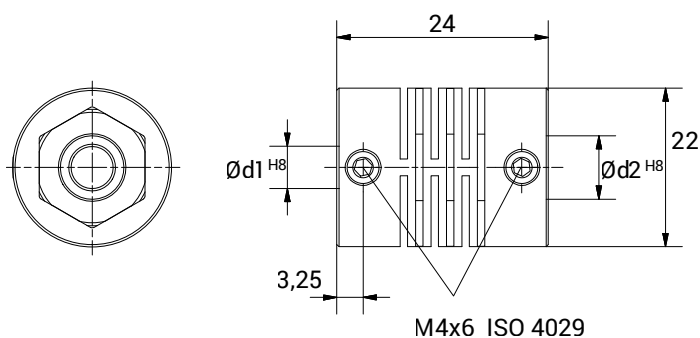

TECHNICAL DATA		
Maximum speed	min ⁻¹	10.000
Maximum torque	Ncm	80
Radial misalignment max.	mm.	± 0,3
Axial misalignment max.	mm.	± 0,3
Angular misalignment max.	degree	± 3
Torsional stiffness	Nm/rad	38
Radial stiffness	N/mm	115
Moment of inertia	gcm ²	7
Clamping torque max.	Ncm	120
Working temperature range	°C	-10/+80
Weight	g	10
Hubs material		Stainless steel AISI 316L
Body material		Polyamide 6.6 fiber glass reinforced

DIMENSIONS		
External diameter	Ø	22
Length	mm.	24
Screw position	mm.	3,25
Screw thread		M 4x6
Standard hole combinations d1 H8 / d2 H8	mm.	6/6 - 6/10 - 10/10