

GMPG 2224

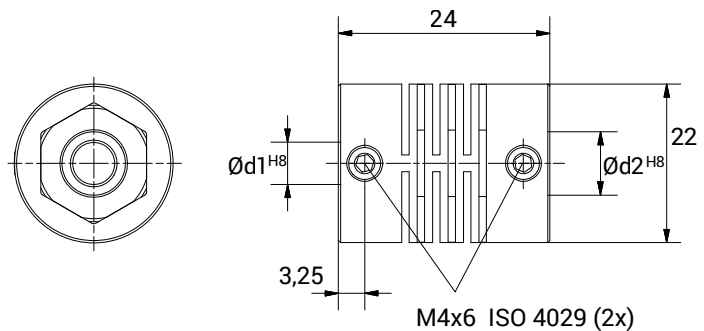

CHARACTERISTICS

- Highly cost-effective coupling built using die-casting technique.
- Metal parts fitted into hubs allow for optimal shaft connection.
- Thermally and electrically insulating.



| TECHNICAL DATA | | |
|---------------------------|-------------------|--------------------------------------|
| Maximum speed | min ⁻¹ | 10.000 |
| Maximum torque | Ncm | 80 |
| Radial misalignment max. | mm. | ± 0,3 |
| Axial misalignment max. | mm. | ± 0,3 |
| Angular misalignment max. | degree | ± 3 |
| Torsional stiffness | Nm/rad | 38 |
| Radial stiffness | N/mm | 115 |
| Moment of inertia | gcm ² | 7 |
| Clamping torque max. | Ncm | 120 |
| Working temperature range | °C | -10/+80 |
| Weight | g | 10 |
| Hubs material | | Aluminium |
| Body material | | Polyamid 6.6 fibreglas reinforced |

| DIMENSIONS | | |
|--|-----|---|
| External diameter | Ø | 22 |
| Length | mm. | 24 |
| Screw position | mm. | 3,25 |
| Screw thread | | M 4x6 |
| Standard hole combinations d1 H8/ d2 H8 | mm. | 4/4 - 4/5 - 4/6 - 4/8 - 4/10 - 5/5 5/6 - 5/8 - 5/10 - 6/6 - 6/8 6/10 - 8/8 - 8/10 - 10/10 |