

GSXV 2429

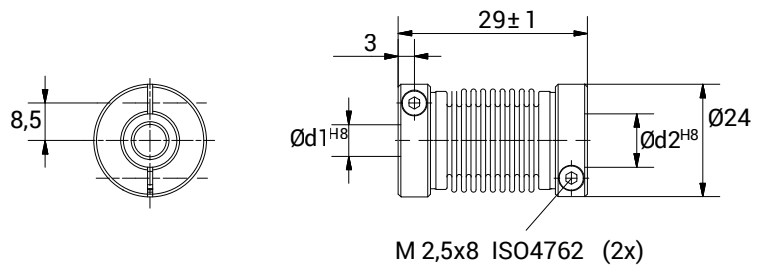

CHARACTERISTICS

- Coupling obtained from two anodized aluminium hubs with special steel bellows.
- Unique misalignment correction capacity.
- High torque rigidity.
- Backlash and vibration free.
- Outstanding servo control.
- Clamp fixing system.



| TECHNICAL DATA | | |
|---------------------------|-------------------|--------------------|
| Maximum speed | min ⁻¹ | 10.000 |
| Maximum torque | Nm | 1,2 |
| Radial misalignment max. | mm. | ± 0,25 |
| Axial misalignment max. | mm. | ± 0,4 |
| Angular misalignment max. | degree | ± 4 |
| Torsional stiffness | Nm/rad | 150 |
| Radial stiffness | N/mm | 25 |
| Moment of inertia | gcm ² | 15 |
| Clamping torque max. | Ncm | 100 |
| Working temperature range | °C | -40/+140 |
| Weight | g | 17 |
| Hubs material | | Anodised aluminium |
| Bellow material | | Stainless steel |

| DIMENSIONS | | |
|---|-----|--|
| External diameter | Ø | 24 |
| Length | mm. | 29 |
| Screw thread | | M 2,5x8 |
| Screw position | mm. | 3 |
| S | mm. | 8,5 |
| Standard hole combinations d1 H8 / d2 H8 | mm. | 6/6 - 6/8 - 6/10 - 6/12 - 8/8 - 8/10 8/12 - 10/10 - 10/12 - 12/12 |