

# GSXV 2135



## CHARACTERISTICS



- Coupling obtained from two anodized aluminium hubs with special steel bellows.
- Unique misalignment correction capacity.
- High torque rigidity.
- Backlash and vibration free.
- Outstanding servo control.
- Clamp fixing system.

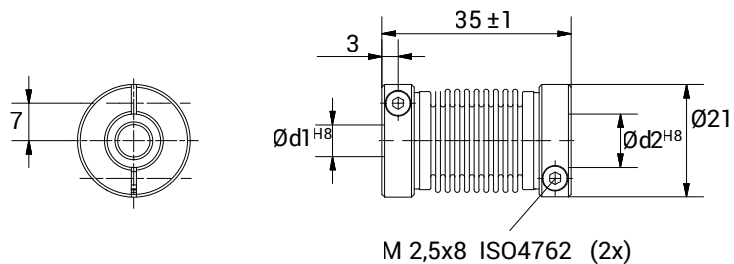

TECHNICAL DATA		
Maximum speed	min <sup>-1</sup>	10.000
Maximum torque	Nm	1
Radial misalignment max.	mm.	± 0,3
Axial misalignment max.	mm.	± 0,5
Angular misalignment max.	degree	± 4
Torsional stiffness	Nm/rad	140
Radial stiffness	N/mm	10
Moment of inertia	gcm <sup>2</sup>	9,5
Clamping torque max.	Ncm	100
Working temperature range	°C	-40/+140
Weight	g	16
Hubs material		Anodised aluminium
Bellow material		Stainless steel

DIMENSIONS		
External diameter	Ø	21
Length	mm.	35
Screw thread		M 2,5x8
Screw position	mm.	3
S	mm.	7
Standard hole combinations d1 H8 / d2 H8	mm.	4/4 - 4/5 - 4/6 - 4/6,35 - 4/8 - 4/9,52 4/10 - 5/5 - 5/6 - 5/6,35 - 5/8 - 5/9,52 5/10 - 6/6 - 6/6,35 - 6/8 - 6/9,52 6/10 - 6,35/6,35 - 6,35/8 - 6,35/9,52 6,35/10 - 8/8 - 8/9,52 - 8/10 9,52/9,52 - 9,52/10 - 10/10