

GSXG 2035



CHARACTERISTICS



- Coupling obtained from two anodized aluminium hubs with special steel bellows.
- Unique misalignment correction capacity.
- High torque rigidity.
- Backlash and vibration free.
- Outstanding servo control.
- Screw fixing system.

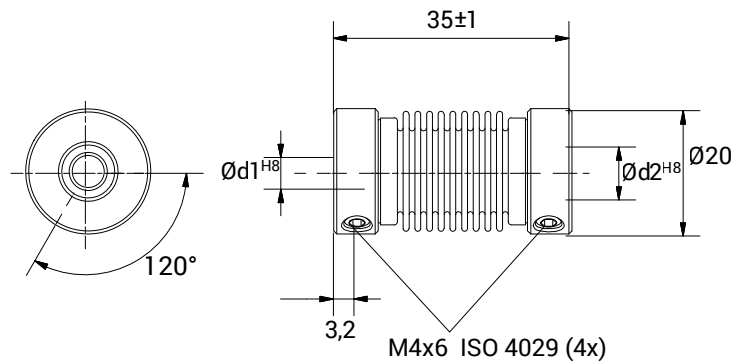

| TECHNICAL DATA | | |
|---------------------------|-------------------|--------------------|
| Maximum speed | min ⁻¹ | 10.000 |
| Maximum torque | Nm | 1 |
| Radial misalignment max. | mm. | ± 0,3 |
| Axial misalignment max. | mm. | ± 0,5 |
| Angular misalignment max. | degree | ± 4 |
| Torsional stiffness | Nm/rad | 140 |
| Radial stiffness | N/mm | 10 |
| Moment of inertia | gcm ² | 9 |
| Clamping torque max. | Ncm | 150 |
| Working temperature range | °C | -40/+140 |
| Weight | g | 16 |
| Hubs material | | Anodised aluminium |
| Bellow material | | Stainless steel |

| DIMENSIONS | | |
|---|-----|---|
| External diameter | Ø | 20 |
| Length | mm. | 35 |
| Screw position | mm. | 3,2 |
| Screw thread | | M 4x6 |
| Standard hole combinations d1 H8 / d2 H8 | mm. | 4/4 - 4/5 - 4/6 - 4/6,35 - 4/8 - 4/9,52 4/10 - 4/12 - 5/5 - 5/6 - 5/6,35 - 5/8 5/9,52 - 5/10 - 5/12 - 6/6 - 6/6,35 - 6/8 6/9,52 - 6/10 - 6/12 - 6,35/6,35 - 6,35/8 6,35/9,52 - 6,35/10 - 6,35/12 - 8/8 8/9,52 - 8/10 - 8/12 - 9,52/9,52 - 9,52/10 9,52/12 - 10/10 - 10/12 - 12/12 |