

# GSNV 1733

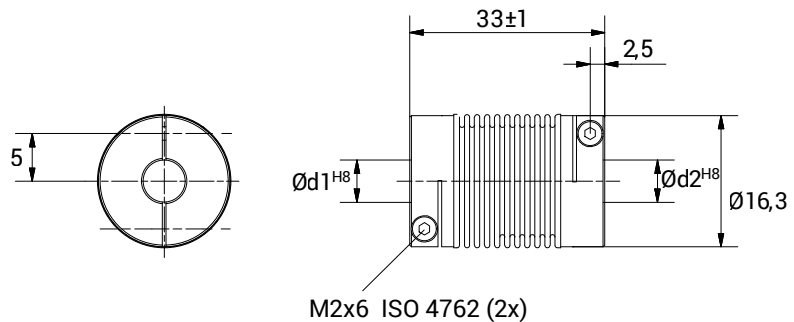

## CHARACTERISTICS

- Coupling obtained from two anodized aluminium hubs with special nickel bellows.
- Unique misalignment correction capacity; high torque rigidity.
- Backlash and vibration free.
- Outstanding in measuring system.
- Available also in stainless steel version.
- The technical data below applies to uniform stress. Otherwise, please contact our technical department.



TECHNICAL DATA		
Maximum speed	min <sup>-1</sup>	10.000
Maximum torque	Ncm	39
Radial misalignment max.	mm.	± 0,72
Axial misalignment max.	mm.	± 3,09
Angular misalignment max.	degree	± 14
Torsional stiffness	Nm/rad	80
Radial stiffness	N/mm	5,8
Moment of inertia	gcm <sup>2</sup>	4,89
Clamping torque max.	Ncm	35
Working temperature range	°C	-30/+120
Weight	g	11,5
Hubs material		Anodised aluminium
Bellow material		Nickel

DIMENSIONS		
External diameter	Ø	16,3
Lenght	mm.	33
Screw thread		M 2x6
Screw position	mm.	2,5
S	mm.	5
Standard hole combinations d1 H8/ d2 H8	mm.	3/3 - 3/4 - 3/5 - 3/6 - 4/4 - 4/5 - 4/6 5/5 - 5/6 - 6/6