

GSNG 1730



CHARACTERISTICS



- Coupling obtained from two anodized aluminium hubs with special nickel bellows.
- Unique misalignment correction capacity; high torque rigidity.
- Backlash and vibration free.
- Outstanding in measuring system.
- Available also in stainless steel version.
- The technical data below applies to uniform stress. Otherwise, please contact our technical department.

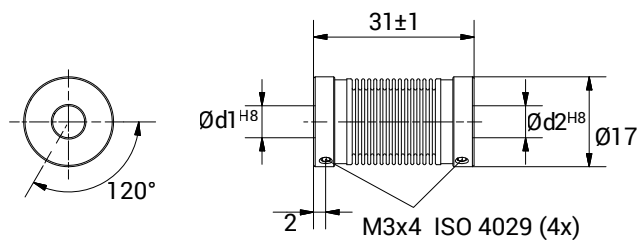

TECHNICAL DATA		
Maximum speed	min ⁻¹	10.000
Maximum torque	Ncm	39
Radial misalignment max.	mm.	± 0,72
Axial misalignment max.	mm.	± 3,09
Angular misalignment max.	degree	± 14
Torsional stiffness	Nm/rad	80
Radial stiffness	N/mm	3
Moment of inertia	gcm ²	3,81
Clamping torque max.	Ncm	132
Working temperature range	°C	-30/+120
Weight	g	10
Hubs material		Anodised aluminium
Bellow material		Nickel

DIMENSIONS		
External diameter	Ø	17
Lenght	mm.	31
Screw position	mm.	2
Screw thread		M 3x4
Standard hole combinations d1 H8 / d2 H8	mm.	4/4 - 4/5 - 4/6 - 4/6,35 - 4/8 - 4/10 - 5/5 5/6 - 5/6,35 - 5/8 - 5/10 - 6/6 - 6/6,35 6/8 - 6/10 - 6,35/6,35 - 6,35/8 - 6,35/10 8/8 - 8/10 - 10/10