

GSNG 1223



CHARACTERISTICS



- Coupling obtained from two anodized aluminium hubs with special nickel bellows.
- Unique misalignment correction capacity; high torque rigidity.
- Backlash and vibration free.
- Outstanding in measuring system.
- Available also in stainless steel version.
- The technical data below applies to uniform stress. Otherwise, please contact our technical department.

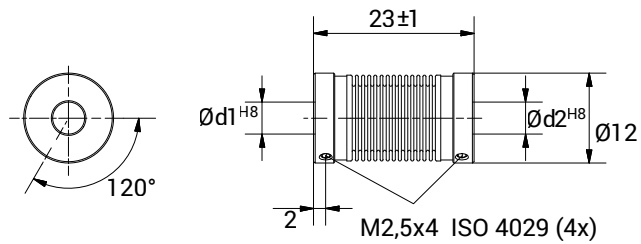

TECHNICAL DATA		
Maximum speed	min ⁻¹	10.000
Maximum torque	Ncm	13
Radial misalignment max.	mm.	± 0,54
Axial misalignment max.	mm.	± 2,29
Angular misalignment max.	degree	± 15
Torsional stiffness	Nm/rad	28
Radial stiffness	N/mm	4,2
Moment of inertia	gcm ²	1,85
Clamping torque max.	Ncm	79
Working temperature range	°C	-30/+120
Weight	g	10
Hubs material		Stainless steel
Bellow material		Nickel

DIMENSIONS		
External diameter	Ø	12
Length	mm.	23
Screw position	mm.	2
Screw thread		M2,5x4
Standard hole combinations d1 H8 / d2 H8	mm.	2/2 - 2/3 - 2/4 - 2/5 - 2/6 - 3/3 - 3/4 - 3/5 3/6 - 4/4 - 4/5 - 4/6 - 5/5 - 5/6 - 6/6