

GMXG 1635



CHARACTERISTICS



- Coupling realised with stainless steel hubs and spring made of nickel-plated steel.
- Extremely sturdy model.
- Excellent compensation for misalignment.
- High torque rigidity.

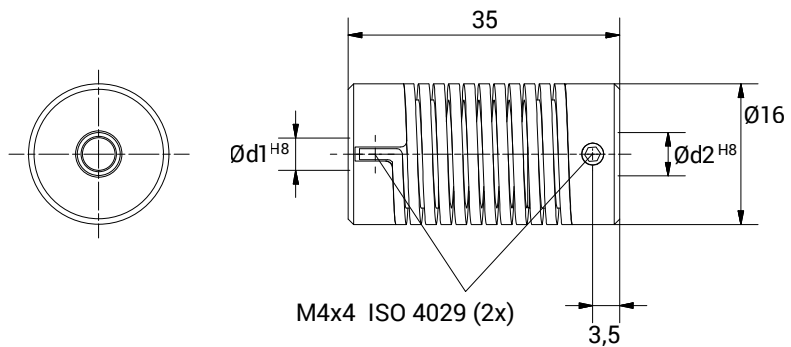

TECHNICAL DATA		
Maximum speed	min ⁻¹	3.000
Maximum torque	Ncm	50
Radial misalignment max.	mm.	± 1
Axial misalignment max.	mm.	± 1
Angular misalignment max.	degree	± 5
Torsion angle at the half of nominal torque	degree	50
Clockwise in view of propulsive shaft	degree	70
Moment of inertia	gcm ²	13,6
Clamping torque max.	Ncm	150
Working temperature range	°C	-40/+150
Weight	g	35
Hubs material		Stainless steel AISI 303
Spring material		Nickel plated steel 1.1200

DIMENSIONS		
External diameter	Ø	16
Length	mm.	35
Screw position	mm.	3,5
Screw thread		M 4x4
Standard hole combinations d1 H8 / d2 H8	mm.	4/4 - 4/5 - 4/6 - 4/8 - 5/5 - 5/6 - 5/8 6/6 - 6/8 - 8/8