

GMXG 1225



CHARACTERISTICS



- Coupling realised with stainless steel hubs and spring made of nickel-plated steel.
- Extremely sturdy model.
- Excellent compensation for misalignment.
- High torque rigidity.

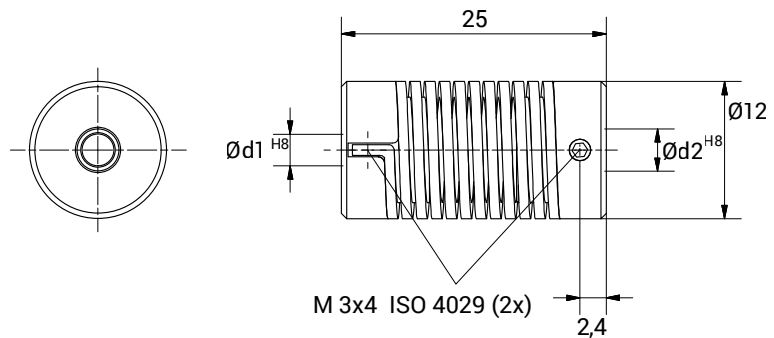

TECHNICAL DATA		
Maximum speed	min ⁻¹	8.000
Maximum torque	Ncm	15
Radial misalignment max.	mm.	± 0,5
Axial misalignment max.	mm.	± 0,5
Angular misalignment max.	degree	± 5
Torsion angle at the half of nominal torque	degree	40
Clockwise in view of propulsive shaft	degree	60
Moment of inertia	gcm ²	3,5
Clamping torque max.	Ncm	70
Working temperature range	°C	-40/+150
Weight	g	18
Hubs material		Stainless steel AISI 303
Spring material		Nickel plated steel 1.1200

DIMENSIONS		
External diameter	Ø	12
Length	mm.	25
Screw position	mm.	2,4
Screw thread		M 3x4
Standard hole combinations d1 H8 / d2 H8	mm.	3/3 - 3/4 - 3/5 - 3/6 - 4/4 - 4/5 - 4/6 5/5 - 5/6 - 6/6