

GEXV 2532

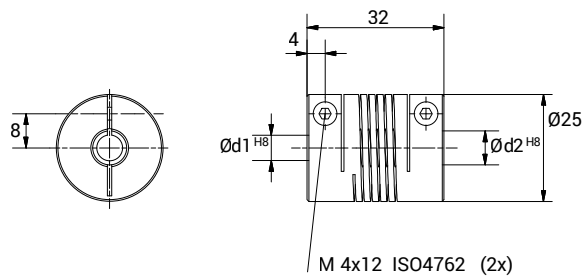

CHARACTERISTICS

- Coupling obtained from one piece of material realised in stainless steel AISI 303.
- Screw and clamp fixing system.
- Suited to countless applications.
- Backlash, vibration and maintenance free.
- Unique misalignment correction.
- High torque rigidity.
- Working temperature range: $-40\text{ °C} \div +180\text{ °C}$.



TECHNICAL DATA		
Maximum speed	min ⁻¹	6.000
Maximum torque	Nm	2
Radial misalignment max.	mm.	± 0,35
Axial misalignment max.	mm.	± 0,5
Angular misalignment max.	degree	± 4
Torsional stiffness	Nm/rad	29
Radial stiffness	N/mm	150
Moment of inertia	gcm ²	84
Clamping torque max.	Ncm	150
Weight	g	88
Material		Stainless steel AISI 303

DIMENSIONS		
External diameter	∅	25
Length	mm.	32
Screw thread		M 3x10
Screw position	mm.	4
S	mm.	8
Standard hole combinations d1 H8 / d2 H8	mm.	6/6 - 6/8 - 6/10 - 8/8 - 8/10 - 10/10