

GEL 500-S

CHARACTERISTICS

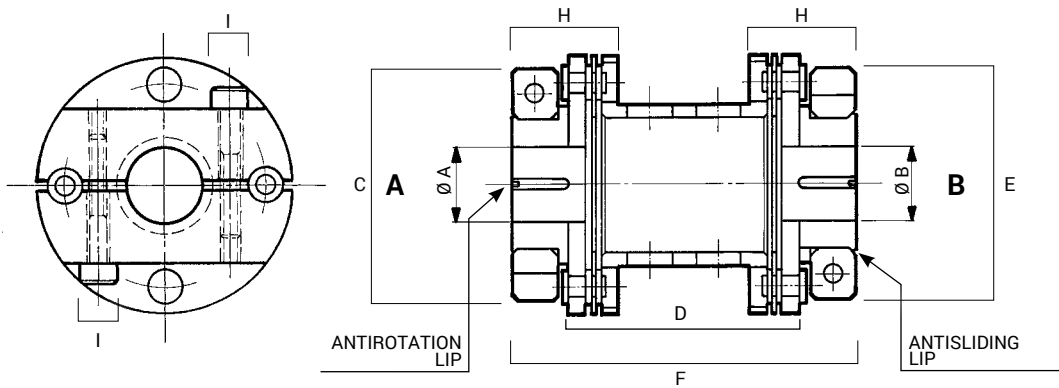

- The fin-couplings DIN.AL., belonging to series "GEL- 500-S" are usually used for the connection of tachogenerators, encoders, contactors, motors, measuring instruments and for every application where a constant rotational movement in the four quadrants is required and where an absolute torque rigidity is required, even when the shafts coupling is not perfectly lined up.
- The particular dynamic construction with clamps in light alloy, allow the blocking of the coupling without using screws or keys.
- Patented in Italy, Germany and France.



TECHNICAL DATA			
Nominal torque	T_N	Nm	1,53
Maximum torque	T_S	Nm	2,20
Axial misalignment max.	ΔW_a	mm.	0,8
Radial misalignment max.	ΔW_r	mm.	0,7
Angular misalignment	ΔW_w	rad	0,02618
Moment of inertia	J	$\text{Kg m}^2 \times 10^{-6}$	11,166
Maximum speed	n max	min^{-1}	45.000
Dynamic torsional stiffness $\times 10^2$	$C_{w \text{ dym}}$	Nm/rad	24,815
Weight	m	Kg	0,067

STANDARD HOLES							
AH7	BH7	C	D	E	F	H	I
5 - 6 - 7 - 8 - 9 - 9,52 - 10 11 - 12 - 14 - 15		34	33,6	38	50	10,7	M3x16