

GEL 4000-C

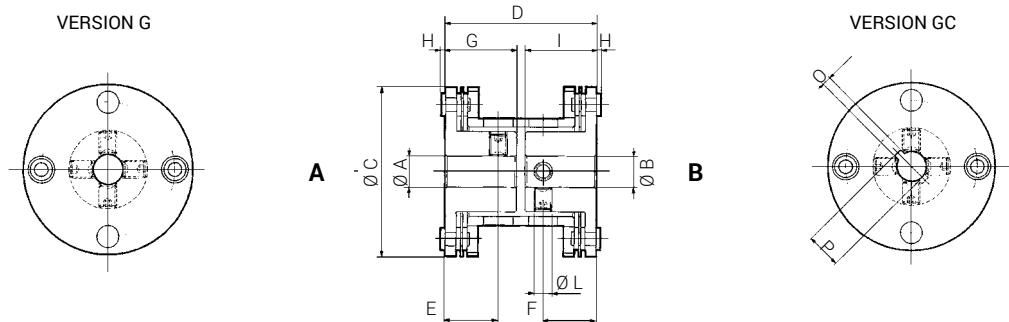

CHARACTERISTICS

- The double hubs inside the body ensure small overall dimensions and the same elasticity.
- The large bores on the central body make it easy to reach the fastening screws.
- A key and screw version is also available.
- They are used to connect tachogenerators, encoders, motors, gauges and for any other application where constant rotational movement in the four quadrants is required and where absolute torque rigidity is needed even when shaft coupling is not perfectly lined up.



TECHNICAL DATA			
Nominal torque	T_N	Nm	1,53
Maximum torque	T_S	Nm	2,20
Axial misalignment max.	ΔW_a	mm.	0,8
Radial misalignment max.	ΔW_r	mm.	0,7
Angular misalignment max	ΔW_w	rad	0,02618
Moment of inertia	J	Kg m ² x10 ⁻⁶	8,451
Maximum speed	n max	min ⁻¹	45.000
Dynamic torsional stiffness x10 ²	$C_{w\ dym}$	Nm/rad	24,815
Weight	m	Kg	0,052

STANDARD HOLES									
AH7	BH7	C	D	E	F	G	H	I	L
3 - 7 - 8 - 10 - 11		38	33,6	12	12	17	1	17	M4

KEYWAY		
H7	O	P
6	2	7
7	2	8
8	3	9
10	3	11,4
11	4	12,8