

# GEL 3000 R-C

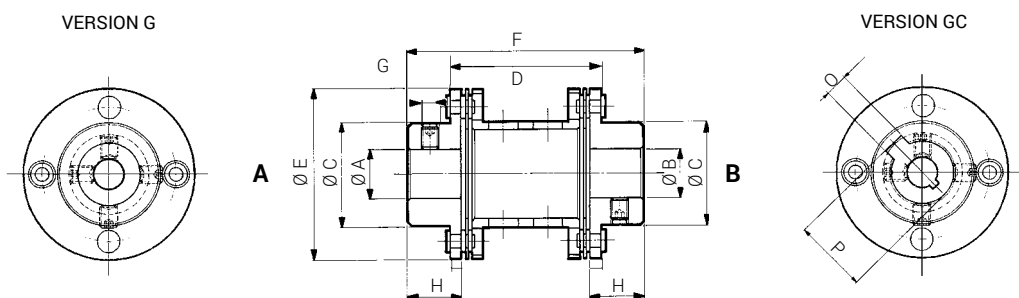

## CHARACTERISTICS

- The DIN.AL fin couplings of the GEL 3000 R series have short outer double hubs which make it possible to connect large shafts, overall dimensions being very small.
- A key and screw version is also available.
- They are used to connect tachogenerators, encoders, motors, gauges and for any other application where constant rotational movement in the four quadrants is required and where absolute torque rigidity is needed even when shaft coupling is not perfectly lined up.



TECHNICAL DATA			
Nominal torque	$T_N$	Nm	1,53
Maximum torque	$T_S$	Nm	2,20
Axial misalignment max.	$\Delta W_a$	mm.	0,8
Radial misalignment max.	$\Delta W_r$	mm.	0,7
Angular misalignment	$\Delta W_w$	rad	0,02618
Moment of inertia	J	$\text{Kg m}^2 \times 10^{-6}$	9,549
Maximum speed	n max	$\text{min}^{-1}$	45.000
Dynamic torsional stiffness $\times 10^2$	$C_{w \text{ dym}}$	Nm/rad	24,815
Weight	m	Kg	0,058

STANDARD HOLES								
AH7	BH7	C	D	E	F	G	H	I
3 - 6 - 7 - 8 - 9,52 10 - 11 - 14		23	33,6	38	52	5	11,7	M4

KEYWAY		
H7	O	P
6	2	7
7	2	8
8	3	9
10	3	11,4
11	4	12,8
12	4	13,1
14	5	16,3