

GEL 1000-C

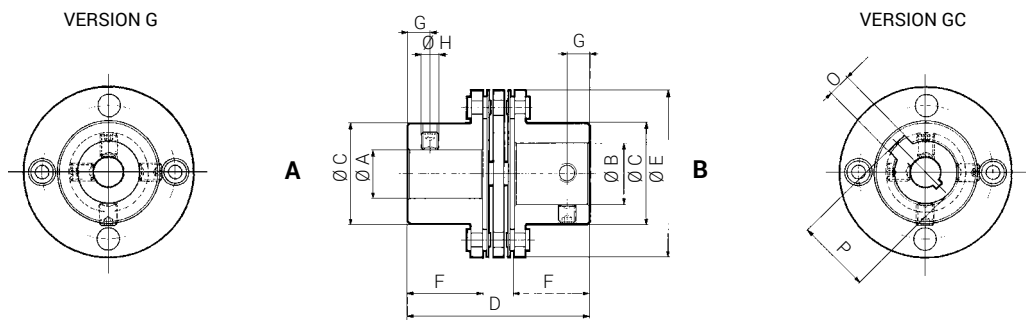

CHARACTERISTICS

- The connection of the two hubs to a central body of a given size ensures the same elasticity, yet very small overall dimensions.
- A key and screw version is also available.
- They are used to connect tachogenerators, encoders, motors, gauges and for any other application where constant rotational movement in the four quadrants is required and where absolute torque rigidity is needed even when shaft coupling is not perfectly lined up.



TECHNICAL DATA			
Nominal torque	T_N	Nm	1,53
Maximum torque	T_S	Nm	2,20
Axial misalignment max.	ΔW_a	mm.	0,4
Radial misalignment max.	ΔW_r	mm.	0,35
Angular misalignment	ΔW_w	rad	0,02618
Moment of inertia	J	Kg m ² x10 ⁻⁶	5,350
Maximum speed	n max	min ⁻¹	45.000
Dynamic torsional stiffness x10 ²	$C_{w \text{ dym}}$	Nm/rad	24,815
Weight	m	Kg	0,040

STANDARD HOLES		C	D	E	F	G	H
AH7	BH7						
3 - 5 - 6 - 7 - 8 - 9,52 10 - 11 - 14		23	41	38	17	5	M4

KEYWAY		
H7	O	P
6	2	7
7	2	8
8	3	9
10	3	11,4
11	4	12,8
12	4	13,1
14	5	16,3