

# GEAV 1928

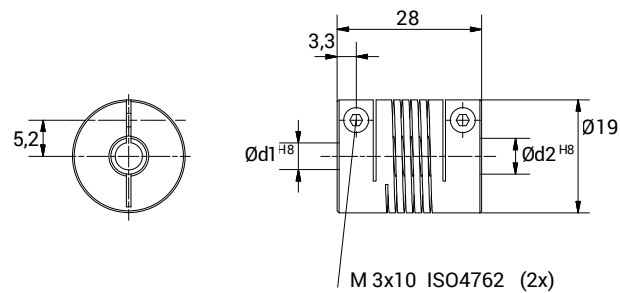

## CHARACTERISTICS

- Coupling obtained from one piece of material.
- Clamp fixing system.
- Suited to countless applications.
- Backlash, vibration and maintenance free.
- Unique misalignment correction.
- High torque rigidity.



TECHNICAL DATA		
Maximum speed	min <sup>-1</sup>	6.000
Maximum torque	Ncm	80
Radial misalignment max.	mm.	± 0,25
Axial misalignment max.	mm.	± 0,4
Angular misalignment max.	degree	± 4
Torsional stiffness	Nm/rad	8
Radial stiffness	N/mm	36
Moment of inertia	gcm <sup>2</sup>	8,7
Clamping torque max.	Ncm	120
Working temperature range	°C	-30/+150
Weight	g	16
Material		Anodised aluminium

DIMENSIONS		
External diameter	Ø	19
Length	mm.	28
Screw thread		M 3x10
Screw position	mm.	3,3
S	mm.	5,2
Standard hole combinations d1 H8 / d2 H8	mm.	4/4 - 4/6 - 5/5 - 5/6 - 5/6,35 - 6/6 6/6,35 - 6,35/6,35