

# GEAV 1625

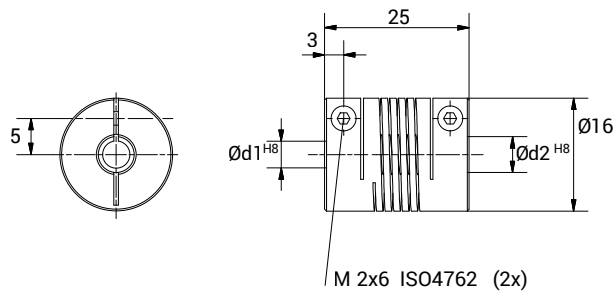

## CHARACTERISTICS

- Coupling obtained from one piece of material.
- Clamp fixing system.
- Suited to countless applications.
- Backlash, vibration and maintenance free.
- Unique misalignment correction.
- High torque rigidity.



TECHNICAL DATA		
Maximum speed	min <sup>-1</sup>	6.000
Maximum torque	Ncm	60
Radial misalignment max.	mm.	± 0,2
Axial misalignment max.	mm.	± 0,3
Angular misalignment max.	degree	± 3,5
Torsional stiffness	Nm/rad	5,5
Radial stiffness	N/mm	30
Moment of inertia	gcm <sup>2</sup>	3,8
Clamping torque max.	Ncm	50
Working temperature range	°C	-30/+150
Weight	g	10
Material		Anodised aluminium

DIMENSIONS		
External diameter	$\varnothing$	16
Length	mm.	25
Screw thread		M 2x6
Screw position	mm.	3
S	mm.	5
Standard hole combinations d1 H8 / d2 H8	mm.	2/2 - 2/4 - 2/6 - 3/3 - 3/5 - 3/6 - 4/4 4/5 - 4/6 - 5/5 - 5/6