

GEAV 1421

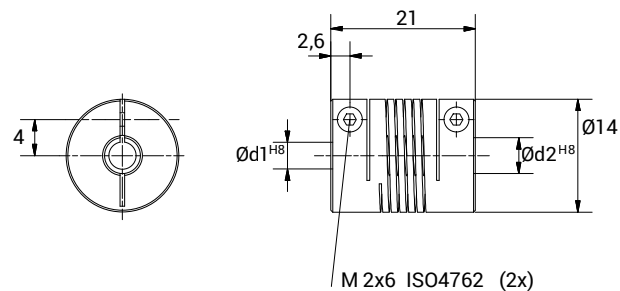

CHARACTERISTICS

- Coupling obtained from one piece of material.
- Clamp fixing system.
- Suited to countless applications.
- Backlash, vibration and maintenance free.
- Unique misalignment correction.
- High torque rigidity.



TECHNICAL DATA		
Maximum speed	min ⁻¹	6.000
Maximum torque	Ncm	50
Radial misalignment max.	mm.	± 0,2
Axial misalignment max.	mm.	± 0,25
Angular misalignment max.	degree	± 3
Torsional stiffness	Nm/rad	4,5
Radial stiffness	N/mm	22
Moment of inertia	gcm ²	1,9
Clamping torque max.	Ncm	50
Working temperature range	°C	-30/+150
Weight	g	6,5
Material		Anodised aluminium

DIMENSIONS		
External diameter	Ø	14
Length	mm.	21
Screw thread		M 2x6
Screw position	mm.	2,6
S	mm.	4
Standard hole combinations d1 H8 / d2 H8	mm.	2/2 - 2/3 - 2/4 - 3/3 - 3/4 - 4/4