

GEAV 1215



CHARACTERISTICS



- Coupling obtained from one piece of material.
- Clamp fixing system.
- Suited to countless applications.
- Backlash, vibration and maintenance free.
- Unique misalignment correction.
- High torque rigidity.

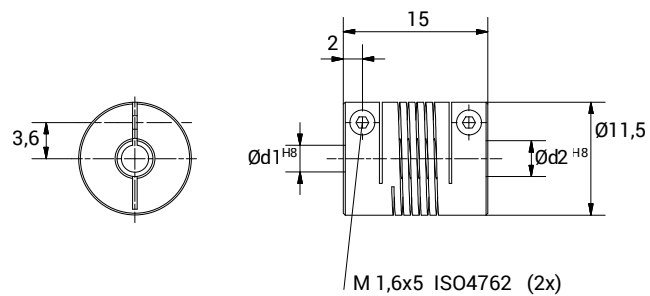

TECHNICAL DATA		
Maximum speed	min ⁻¹	8.000
Maximum torque	Ncm	25
Radial misalignment max.	mm.	± 0,15
Axial misalignment max.	mm.	± 0,2
Angular misalignment max.	degree	± 2
Torsional stiffness	Nm/rad	2,5
Radial stiffness	N/mm	55
Moment of inertia	gcm ²	1
Clamping torque max.	Ncm	30
Working temperature range	°C	-30/+150
Weight	g	3,5
Material		Aluminium

DIMENSIONS		
External diameter	∅	11,5
Length	mm.	15
Screw thread		M 1,6x5
Screw position	mm.	2
S	mm.	3,6
Standard hole combinations d1 H8 / d2 H8	mm.	2/2 - 2/4 - 3/3 - 3/4