

GEAG 1015



CHARACTERISTICS



- Coupling obtained from one piece of material.
- Suited to countless applications. Backlash, vibration and maintenance free.
- Unique misalignment correction.
- High torque rigidity.

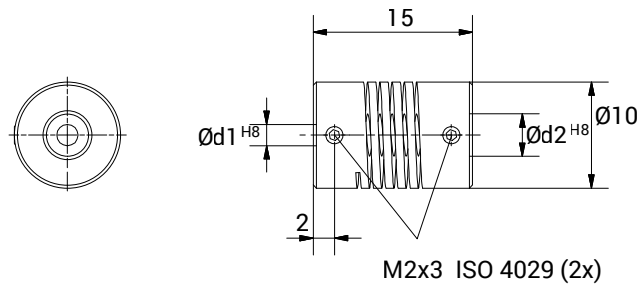

| TECHNICAL DATA | | |
|---------------------------|-------------------|-----------|
| Maximum speed | min ⁻¹ | 8.000 |
| Maximum torque | Ncm | 15 |
| Radial misalignment max. | mm. | ± 0,15 |
| Axial misalignment max. | mm. | ± 0,2 |
| Angular misalignment max. | degree | ± 2 |
| Torsional stiffness | Nm/rad | 2,2 |
| Radial stiffness | N/mm | 22 |
| Moment of inertia | gcm ² | 0,34 |
| Clamping torque max. | Ncm | 15 |
| Working temperature range | °C | -30/ +150 |
| Weight | g | 2,4 |
| Material | | Aluminium |

| DIMENSIONS | | |
|---|-----|--|
| External diameter | Ø | 10 |
| Length | mm. | 15 |
| Screw position | mm. | 2 |
| Screw thread | | M 2x3 |
| Standard hole combinations d1 H8 / d2 H8 | mm. | 2/2 - 2/3 - 2/4 - 2/5 - 3/3 3/4 - 3/5 - 4/4 |