

# E3XV 2532

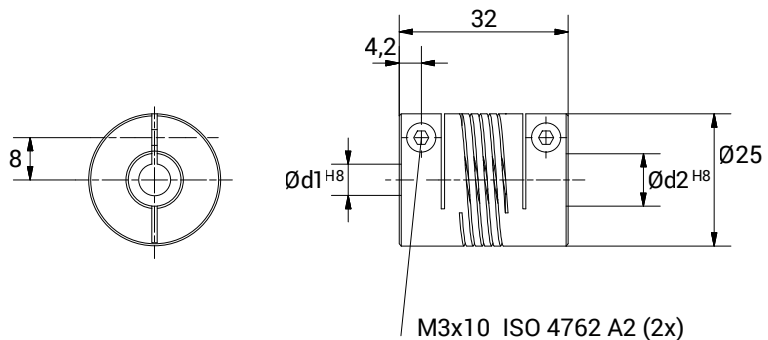

## CHARACTERISTICS

- Coupling obtained from one piece of material realised in stainless steel AISI 303.
- Clamp fixing system.
- Suited to countless applications.
- Backlash, vibration and maintenance free.
- Unique misalignment correction.
- High torque rigidity.



TECHNICAL DATA		
Maximum speed	min <sup>-1</sup>	5.000
Maximum torque	Nm	6
Radial misalignment max.	mm.	± 0,13
Axial misalignment max.	mm.	± 0,2
Angular misalignment max.	degree	± 5
Torsional stiffness	Nm/rad	35
Radial stiffness	N/mm	252
Moment of inertia	gcm <sup>2</sup>	82
Clamping torque max.	Ncm	120
Working temperature range	°C	-40/+180
Weight	g	86
Material		Stainless steel AISI 303

DIMENSIONS		
External diameter	∅	25
Length	mm.	32
Screw thread		M 3x10
Screw position	mm.	4,2
S	mm.	8
Standard hole combinations d1 H8 / d2 H8	mm.	8/8 - 8/9,52 - 9,52/9,52 10/10 - 12/12